

SKYVIEW LABORATORY, INC.
P.O. BOX 273
ROUTE 30 WEST PIT STREET
JENNERSTOWN, PA 15547
(814) 629-5441

BACTERIOLOGICAL REPORT

Name: KANE MAIERS
Address: ROUTE 6 BOX 6678
: KEYSER, WV 26726

Source: WELL
Collected By: CLIENT

Date Collected: 11/19/2009
Time Collected: AM

Date Tested: 11/20/2009
Time Tested: 11:22

Treatment of supply:

Tested by Standard membrane filter method 909 A, M-ENDO media.

RESULTS

Total Coliform bacteria count per 100 ml. = 0

This result indicates a SAFE drinking water supply.

INTERPRETATION

Coliform bacteria are microorganisms recognized as indicators of pollution. They are found in the intestinal tract of all warm blooded animals. If these are present harmful disease causing bacteria may also be present and the water must be considered unsafe.

Surface runoff, poorly sealed wells, and septic systems are often sources of pollution. To disinfect a well add 1 qt. household bleach per 150 ft, run each faucet until the smell of chlorine is detected, and don't use water for 12 hrs. min. Flush out the system and retest after a week of use.

NO COLIFORM OR IRON/SULFUR RELATED BACTERIA PRESENT.

Handwritten signature

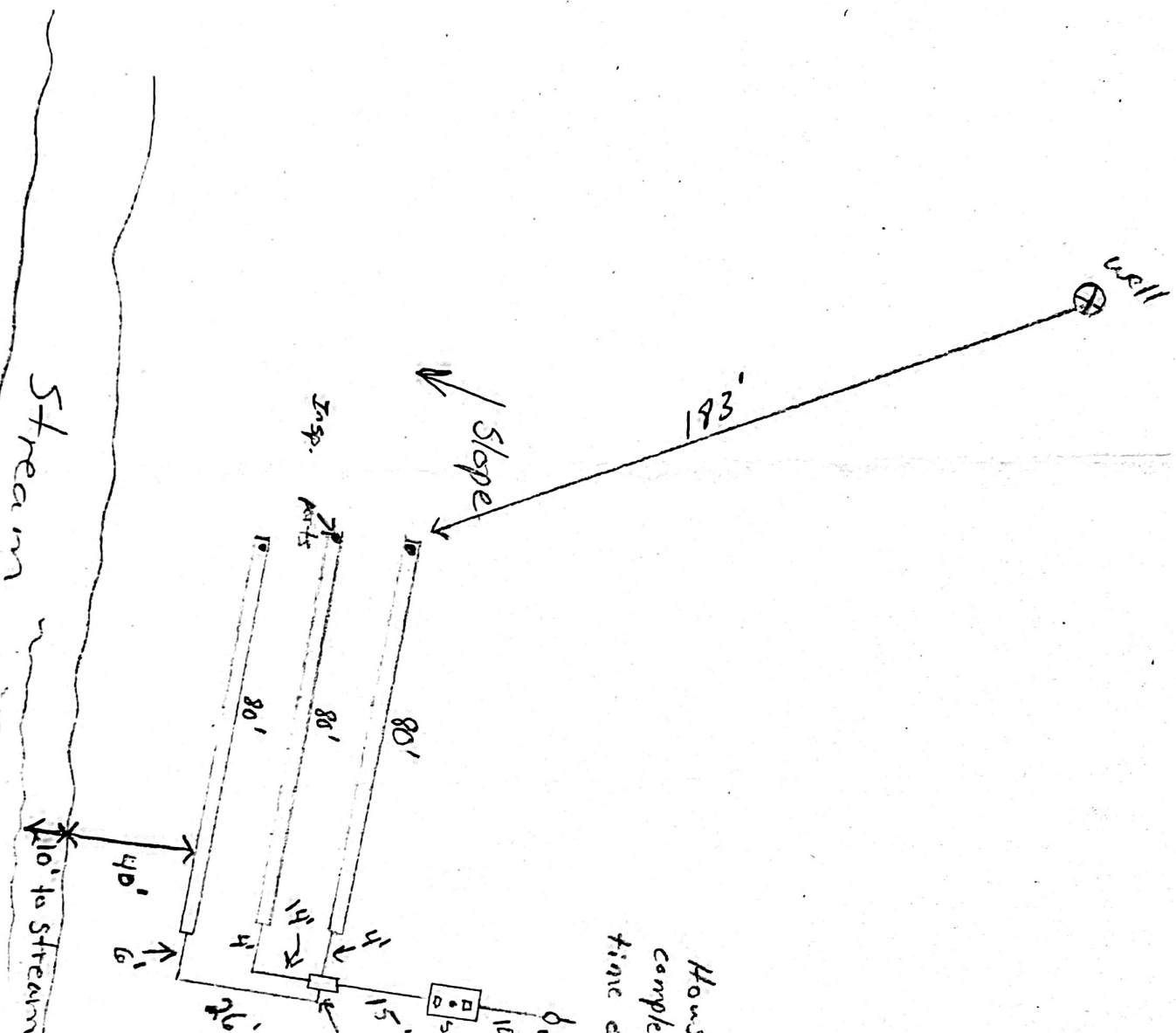

House not completed at time of installation

ok 4" pipe 5 ft. for clean-out

Miranda L. Dunn
 ST-029-10-042
 Elevation = 767'
 N = 39° 29' 34.7"
 W = 78° 48' 36.5"
 Final date = 3-26-2010

STATE OF WEST VIRGINIA

Mineral County HEALTH DEPARTMENT
ON-SITE SEWAGE DISPOSAL SYSTEM PERMIT

Permit No.: ST -029- 10 - 042

Fax Map 341 Parcel # 813
County Road No.:

PERMIT TO BE
PRINTED OR TYPED

Owner: Miranda L. Dunn
Address: RT 6 Box 6678
Keyser, WV 26726

Certified Installer: First Fruits Excavating Inc.
Address: RT 2 Box 651 A
Ridgeley, WV 26753

You are hereby issued a permit to: install, or modify an on-site sewage disposal system located:

1 mile from RT 46 on County Rd #10, Evansdale Sub-Div

Facility: Residence (New) Design Flow: 4BR Lot Size: 15.94 Sq. Ft. (Acres) Water Source: Well

BASED UPON REVIEW OF THE INFORMATION OF YOUR SUBMITTED APPLICATION, DATED 2-25-2010, AND THE PROPER INSTALLATION OF THE HEREIN DESCRIBED SYSTEM, THE SYSTEM SHALL BE IN COMPLIANCE WITH APPLICABLE WEST VIRGINIA SEWAGE SYSTEM RULES AND DESIGN STANDARDS.

The sewage system shall consist of a:

- Septic tank - Capacity: 1000 gallons or more, Constructed of: concrete.
 - Soil disposal system with a minimum equivalency of _____ square feet of conventional gravel trench area.
- Depth to the bottom of the trench or bed installation shall be: 24" inches from original ground surface.
- Gravel system: Lengths of lines: _____, _____, _____, _____, _____ feet, Width: 36" inches.
 - Chamber system: Number of units: _____, Length of lines: 60, 60, 60, 60, _____ units,
Manufacturer of chamber: _____ or 80 80 80
 - Bed system: Gravel, Chamber; Length: _____ feet, Width: _____ feet.
 - Other: Please install with D-Box on level concrete pad.
With speed levelers

This permit is non-transferable and automatically expires 12 months after issue date.

This permit is **NULL and VOID** when official inspection reveals conditions different than those stipulated on the permit or facts are later found that would indicate non-compliance with applicable rules.

All systems must be inspected and approved prior to being covered with earth or placed into use.

The applicant or his agent must notify this department: _____ hours or more prior to planned inspection time.

Sketch of system:

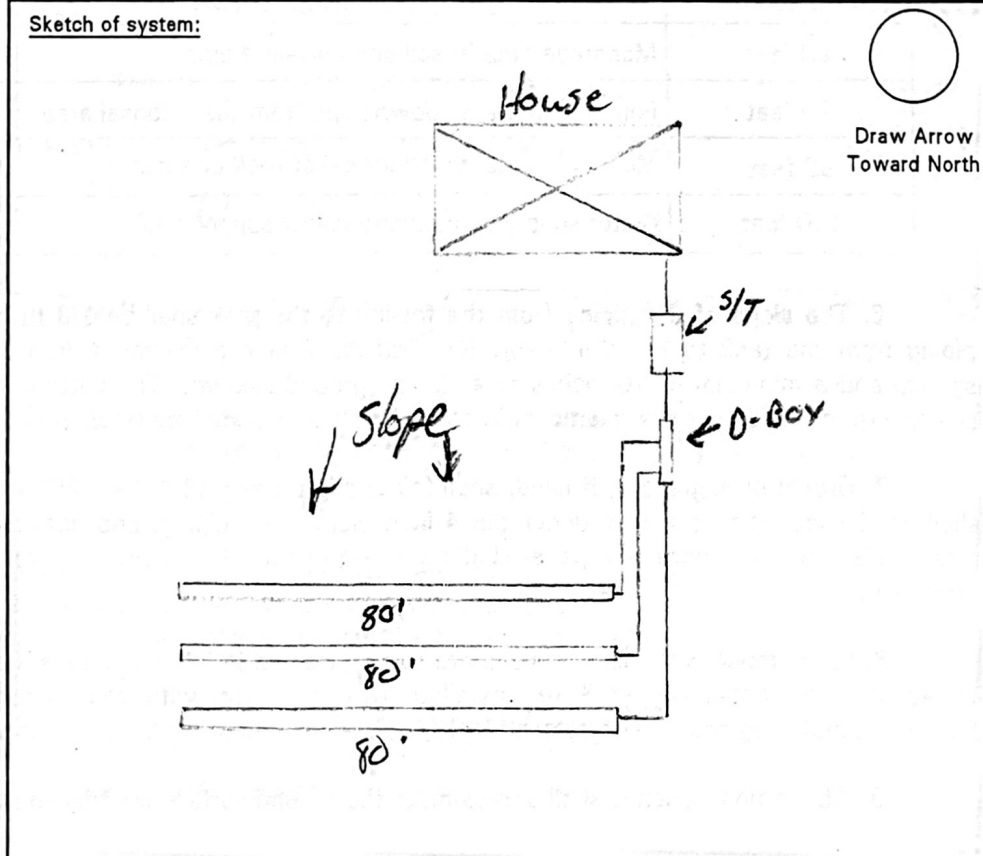

Issue Date 3-2-2010

Mineral Co. / 304-788-1331
County Office / Phone Number

Additional specifications
on reverse:

[Signature]
Health Officer or Sanitarian

MCEF-200
Rev: 4/07

Mineral County Health Department
Application for Individual On-site Sewage Evaluation



Buyer: Maier 785-6562

Name Kane A. Maier Phone (304) 813-9938

Address Rt 6 Box 6678, Keyser, WV 26726

Property Location George's Run Road 0.7 miles from Rt 46.

Property Deed Recorded in: Book No. 297 Page 150 Date Recorded _____

County Tax Map _____ Parcel Number _____ Size of Lot _____ ft² / acres.

Application is hereby made for a site investigation to determine the suitability of the subject property as a site for the small sewage system indicated below:

Septic System () Pit Privy () Vault Privy () Other _____

The results of a percolation test conducted in accordance with the requirements of Legislative Rule 64-17 "Individual and On-Site Sewage Systems (Excerpts)" follows:

Depth of test holes: #1 24", #2 24", #3 20", #4 22"

Time for water to fall six (6) inches in test hole #1 60 minutes

#2 50 minutes

#3 30 minutes

#4 60 minutes

Total 200 minutes divided by 24 = 8.33 minutes/inch

A test hole bored or dug six (6) feet deep is () is not free of water or solid rock.

Percolation test conducted by: Name Ronald K Staggs

Address Rt 6 Box 6612 Keyser WV 26726

Signature Ronald K Staggs Date 11-16-09

A place is provided on the back of this page for a plot layout showing the property lines and relative locations of buildings, water supplies, percolation test holes, six foot hole, and other pertinent features. Parcels less than two (2) acres must show precise location of 10,000 square foot reserve area.

I (we), the undersigned, certify that the information contained herein is correct and accurate to the best of my (our) knowledge. It is further understood that this form is not an application for a permit, and subsequent acceptance of this site by the Mineral County Health Department does not constitute a permit to install a sewage system.

Owner's signature Kane A. Maier Date 11/30/09

Reverse of form must be completed

Plot Layout

In the space below provide a plot layout showing the property lines and relative locations of buildings, water supplies, percolation test holes, six foot hole, and other pertinent features. Parcels less than two (2) acres must show precise location of 10,000 square foot reserve area.

House -x- Water Supply Line ⊗ Water Supply ||||| Trees ⊕ Percolation Test Site ST Septic Tank
 ----- Soil Absorption Line → Direction of Ground Slope _____ Property Line MH Mobile Home

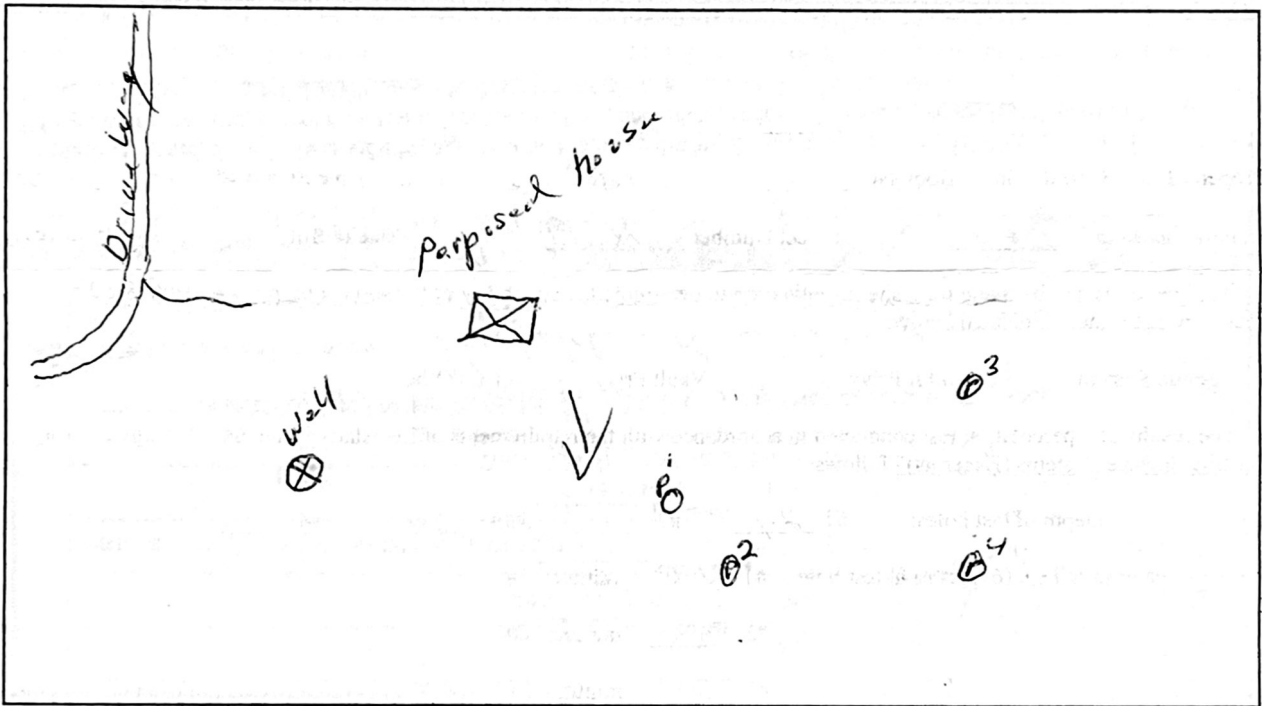

FOR HEALTH DEPARTMENT USE ONLY

Date Received	Date Site Evaluation	Reviewed by	Date Fee Paid	Received From
11-30-09	11-30-09	JED	11-30-09	JED

6' Excavation Observed	Reserve Area Location (GPS Coordinates)	Drainfield Design		
		Depth	ft ² of Trench Area	Trench Separation
OK	1103' 39 29 37.4 78 48 35.9	24"	min 300 ft ² /Bed Resort	6'

Comments: Red clay/shale/shale mix to 40"
 41" to bottom stark transition to gray shale mix to 6' deep.
 (No water) Class **II**

This is to certify that the Mineral County Health Department reviewed the contents of this form and conducted a site visit on the subject property. Based on the information provided it appears that the site () is () is not suitable for the installation of the small sewage system indicated.

Signature John E. DelSigne RS Date 12-1-09

Well Drilling & Testing

S - 229

B.W. SMITH WELL DRILLING INC.

Serving This Area Since 1957
COMPLETE WATER SYSTEMS
GOULDS • PUMPS

Contractors Lic. WV038905
 304-496-9977 • 304-822-4786
 P.O. Box 440, Springfield, West Virginia 26763
 Owner: Mark & Cindy Smith

SOLD TO:	KANE MAIERS	
ADDRESS:	RT. 6 BOX 6678 KEYSER, WV 26726	
COUNTY:		PHONE: ³⁰⁴⁻⁸¹³⁻⁴⁹³⁸ 304-787-6562
DATE:	11-20-09	

TERMS: NET 10 DAYS

QTY.	DESCRIPTION	AMOUNT
1	3/4 Hp 10 Gpm Goulds Pump	\$600 ⁰⁰
180 ft	160 PSI Poly Pipe	\$135⁰⁰
180 ft	1 1/2 Pump Cablr	\$225 ⁰⁰
1	Pitless adaptor	\$40 ⁰⁰
misc	Brass fittings, Clamps, Tape, electrical connections	\$100 ⁰⁰
	Labor to install pump, pipe, + wire in well + Pump well clear + test Take water Test samples	\$200 ⁰⁰
	<u>MINERAL TEST RESULTS:</u>	
	HARDNESS - 4 GRAINS	
	PH - 8.7	
	IRON - 1.2 PPM	
	TDS (TOTAL DISSOLVED SOLIDS) - 236	

A SERVICE CHARGE OF 1-1/2% WILL BE ADDED TO ALL ACCOUNTS OVER 30 DAYS.
 The above well casing pump, pipe equipment, etc., remains the property of Smith Well Drilling until paid in full and Smith Well Drilling shall have the right to go upon the premises without guilt of trespass and reclaim and recover any materials and equipment installed.

The purchaser agrees that it is responsible for attorney's fees and costs of any proceeding to enforce payment of any amounts.
 B.W. Smith Well Drilling does not guarantee water quantity or quality.

TOTAL	\$1,300	⁰⁰
	-	-
TOTAL	\$1,300	⁰⁰