

29 of 30

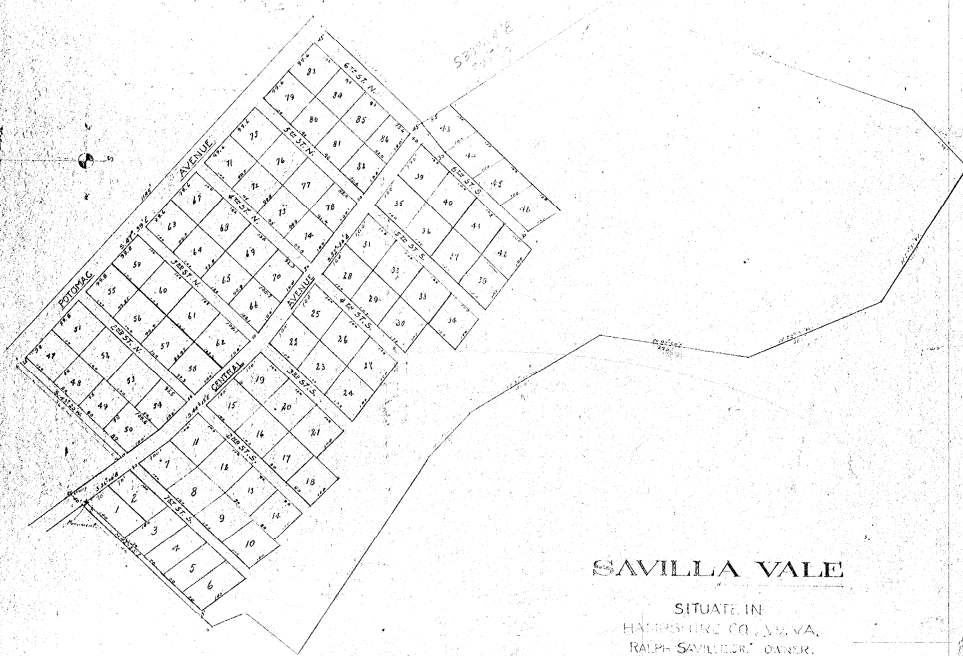
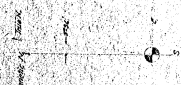

SAVILLA VALE

SITUATE IN
HAMPSHIRE CO., N.H.
RALPH SAVILLER, OWNER.

THE ENGINEERS OF
CASTO & HARRIS, INC.
100 STATE STREET, BOSTON, MASS.
The Map Reduced, the Scale

AS SHOWN ON THE PLAT Declining 57.50
Surveyed in 1917 by W.L. KERR

Scale 1"=100 FT

Aug. 30 1957

Drawn by W.L. KERR

Sheet No. P-5-1