

FINAL PLAT OF OAKRIDGE - WEST LOT NOS. 2 THRU 5 TOTAL AREA: 6.294 ACRES CAPDN DISTRICT HAMPSHIRE COUNTY, WEST VIRGINIA TAX MAP 30, PART OF PARCEL 11

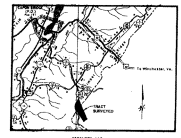

MASTIC COLLECTOR INTERFERED AT... THIS SUBDIVISION HAS BEEN APPROVED BY THE HAMPSHIRE COUNTY PLANNING COMMISSION AS A CLASS II - RESIDENTIAL... CONTRACTED BY THE PLANNING BOARD BY THE DISTRICT ENGINEER



COURSE & DISTANCE CHART

Table with 2 columns: Station, Course & Distance. Lists bearings and distances for various points along the boundary.

DEVELOPER: THOMAS H. ALSTINE, DISTRICT ENGINEER, NO. 411, BOX 778, COOPER SPRING, W. VA. 26041, 655-2964

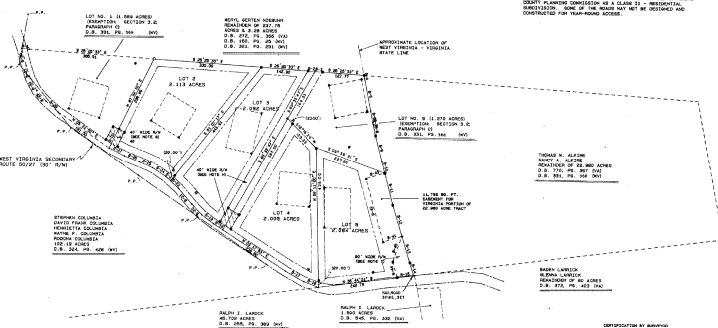

LEGEND

- 1. CALCULATION CHECK
2. RECORD COPY
3. RECORD COPY
4. RECORD COPY
5. RECORD COPY
6. RECORD COPY
7. RECORD COPY
8. RECORD COPY
9. RECORD COPY
10. RECORD COPY

NOTES

NOTE 1. THIS PLAT IS A FINAL PLAT... NOTE 2. THE AREA OF THIS SUBDIVISION... NOTE 3. THIS PLAT IS A FINAL PLAT...

NOTE 4. THIS PLAT IS A FINAL PLAT... NOTE 5. THE AREA OF THIS SUBDIVISION... NOTE 6. THIS PLAT IS A FINAL PLAT...



CERTIFICATION BY SURVEYOR: I, THOMAS H. ALSTINE, DISTRICT ENGINEER, AM A LICENSED SURVEYOR IN THE STATE OF WEST VIRGINIA... I HAVE PERSONALLY CONDUCTED THE SURVEY AND THE PLAT IS TRUE AND CORRECT.

OWNER'S CERTIFICATION

I, THOMAS H. ALSTINE, DISTRICT ENGINEER, AM A LICENSED SURVEYOR IN THE STATE OF WEST VIRGINIA... I HAVE PERSONALLY CONDUCTED THE SURVEY AND THE PLAT IS TRUE AND CORRECT.

APPLICANT'S CERTIFICATION

I, THOMAS H. ALSTINE, DISTRICT ENGINEER, AM A LICENSED SURVEYOR IN THE STATE OF WEST VIRGINIA... I HAVE PERSONALLY CONDUCTED THE SURVEY AND THE PLAT IS TRUE AND CORRECT.

STATE OF WEST VIRGINIA, County of Hampshire, ss. I, County Clerk, do hereby certify that the above is a true and correct copy of the original as recorded in my office.

FINAL PLAT OF OAKRIDGE - WEST S.E.S SERVICES, INC. RODGE C. GAY, L.L.S. NO. 635, 11111 W. MARKET ST., SUITE 100, CHARLOTTE, NC 28215-3105