

Recd
3-13-91

WV STATE DEPARTMENT OF HEALTH
Office of Environmental Health Services
ENVIRONMENTAL ENGINEERING DIVISION

SW258

Wayne Westhoff WELL COMPLETION REPORT

Date(s) 9-18-90 County Hampshire Permit #: DW-14-07-91-09
Town: _____ Area Name/Location Property on 2 1/4 Cabin Run Road, Lot 7
Well Owner: Wycombe Corp, Inc. Address: 645 Madison Ave.
Telephone Number: 212/758-1850 New York, NY
Well Driller: High Point Drilling, Inc. Address: P.O. Box 190
Telephone Number: 725-1644 Charles Town, WV 25414

WELL LOG

DEPTH IN FEET	FORMATIONS: KIND, THICKNESS, AND IF WATER BEARING	REMARKS:
<u>1'-118'</u>	<u>loose sand and shale</u>	Type of Well: <u>limestone</u> Drilling Method: <u>Rotary</u>
<u>114</u>	<u>Bedrock</u>	Well Diameter: <u>6 1/8</u> Casing O.D.: <u>6 5/8</u>
<u>120-225</u>	<u>hard slate and</u>	Well Depth: <u>225</u> Date Completed: <u>7-19-90</u>
	<u>went into limestone</u>	CASING: Length <u>126</u> Feet Height above ground <u>1 1/2</u> Feet
	<u>finished 225 12 GPM</u>	<input checked="" type="checkbox"/> Steel <input type="checkbox"/> Plastic <input type="checkbox"/> Cast Iron
		Other _____ Type _____
		SCREEN
		<input checked="" type="checkbox"/> None Installed
		Type _____ Diameter _____
		Slot/Gauge _____ Length _____
		Set Between _____ Ft. and _____ Ft.

PUMPING OR BAILING TEST

DETAILS	#1	#2	#3
Static Water Level (Ft. Below Grade)	<u>85</u>		
Pumping Rate (GPM)	<u>12</u>		
Pumping Level (Ft Below Grade)	<u>220</u>		
Duration of Test (In Hours)	<u>1 hr.</u>		
Recovery Time to Static Level (In Hours)	<u>16 min</u>		

WELL HEAD

Pitless Adapter: Type, Make, Etc. _____
Well Cap: Type, Make, Etc. Royer Casting
Well Seal: Type, Make, Etc. _____
Well Platform: _____
Length _____ Width _____ Thickness _____
Grouting: Yes No
All Public Water Supplies must be grouted.

I hereby certify that this well was drilled and constructed under my supervision, in compliance with all requirements of the referenced permit, and that this record is true to the best of my knowledge and belief.

Richard Zittle 034
Name Certification No.
High Point Drilling, Inc.
Registered Business Name
Richard Zittle 9-18-90
Signed Date

WEST VIRGINIA
SEPTIC TANK INSPECTION FORM

West Virginia Health Department Installation Permit No. ST-14-94-233

Name of Owner Wayne Westhoff

Address 4325 Evergreen Drive, Dale City, VA 22123

Property Address Eagle Bay Properties Lot #7

DESCRIPTION & NUMBER OF UNITS SERVED

Type Facility Served Home No. Water Closets

Lot Size 26⁺ acres sq. ft. Area suitable for sewage disposal installation sq. ft.

Source of Water Supply well No. Lavatories

No. Bedrooms 2 No. Showers or Tubs No. Baths

No. Garbage Grinders No. Automatic Washers 1

SEPTIC TANK

Material concrete Length x Width x Depth = cubic feet

Liquid Depth ft. Liquid Capacity 1000 gal.

Distance to: Dwelling 21' Water Supply 100 Nearest Property Line 400'

SOIL ABSORPTION SYSTEM

Type Drain Line Material gravelless Trench Width 24 Inches

Trench Depth 24 Inches Total Absorption area in Trench Bottom 600 sq. ft.

Diameter of Drain Line 10 Inches Type Filter Media

No. of Drain Lines 2 Depth Filter Media Under Drain Line Inches

Length of Each Line 100, 100, , ft. Depth Filter Media Over Drain Line in.

Distance of Disposal Field to: (a) Dwelling 30'

(b) Water Supply 130' (c) Nearest Property Line 500'

An inspection of the septic tank system described herein disclosed that said system MEETS (MEETS, DOES NOT MEET) the minimum standards established by the West Virginia State Department of Health.

4-5-94
Date

C. DAVID DUNLAP
Sanitarian

SKETCH OF SYSTEM TO BE DRAWN ON BACK

Note: Copy of this inspection report must be given to owner and the original filed in the Health Department files. PERMANENT RECORD - DO NOT DESTROY.

COUNTY RD 294

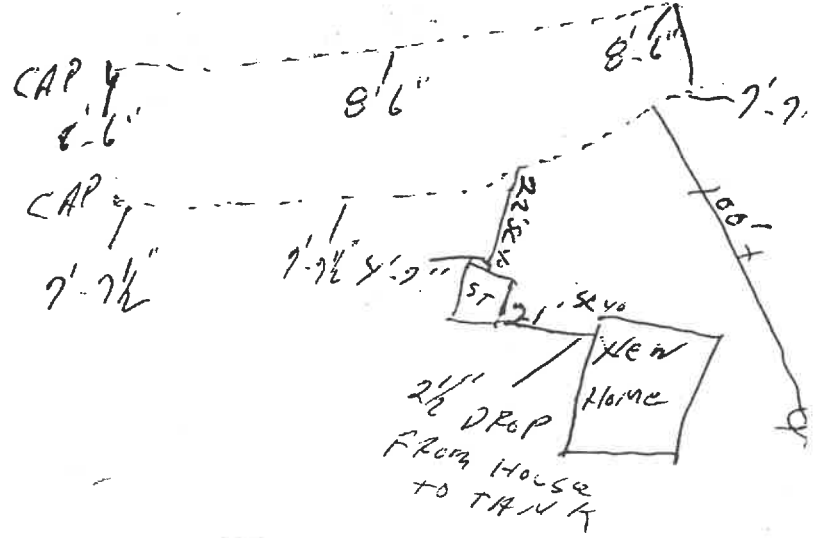

ALL GUTTERS
TIED TO FOUNDATION
DRAINS

DEVELOPMENT RD